

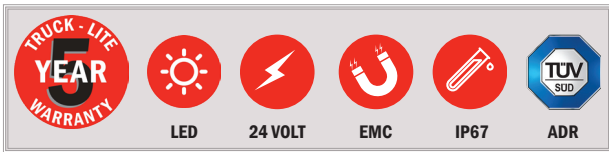

LED REAR LAMP

MODEL 756

Multifunction LED Rear Lamp



756/01/04 Shown

Main Features

- LED Stop, Tail, Fog, Reverse, DI, EOM functions
- LED Sidemarker and Reflex triangle
- Low profile, only 30mm depth
- Horizontal and vertical mounting options
- Compatible with trailer detection systems
- Industry standard DIN connector - TL (UK)

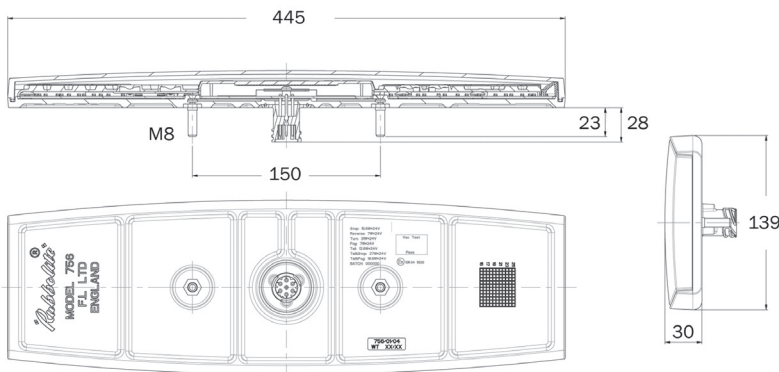

Connection

TL DIN

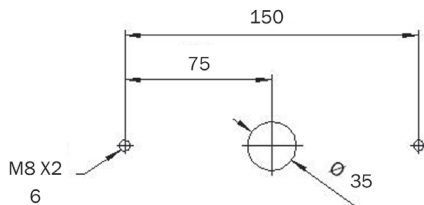

Rubbolite[®]

Part No.	756/01/04
Light Source	LED
Voltage	24 Volt
Dimensions	L 445mm X H 139mm X D 30mm
Housing	Aluminium
Lens	Polycarbonate
Mount/Fixings	M8 Bolts X2 6.0Nm Torque
Connector	DIN Connector - TL (UK)
Functions	Multifunction
Warranty	5 Year
Approvals	ADR Approved, ECE, EMC
Testing	IP67
Application	Trailer - (Truck version available)
Power	Stop: 15.6W - Reverse: 7W - Turn: 31W - Fog: 7W - Tail: 12.6W - Tail & Stop: 27W - Tail & Fog: 18.6W

Part Numbers

- 756/01/04 - Right Hand Multifunction LED Rear Lamp - Horizontal Mount - DIN Connector
- 756/01/05 - Left Hand Multifunction LED Rear Lamp - Horizontal Mount - DIN Connector
- 756/02/04 - Multi-Hand Multifunction LED Rear Lamp - Vertical Mounting - DIN Connector
- 756/03/04 - Multi-Hand Multifunction LED Rear Lamp - Universal Mounting - DIN Connector