

REVISION HISTORY		
REV.	DESCRIPTION	DATE
04	REVISED PER P11047	2013-01-30
A	INITIAL RELEASE PER P11047	2013-02-13
B	REVISE PER P11047	2013-02-27

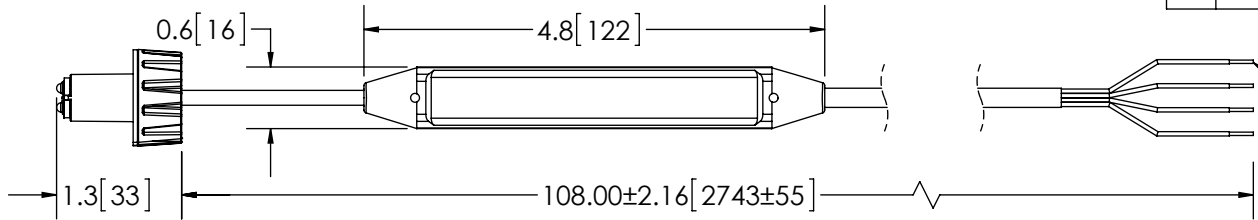

**RIGHT VIEW**

**SPECIFICATIONS**

4-22 AWG WIRE  
 RED - POSITIVE(+)  
 BLACK - NEGATIVE(-)  
 BLUE - SYNC/PATT SEL  
 YELLOW - ALT/SIMULT

- CERTIFICATIONS: **CE**; e; ECE R10; IP-67D, Category 2, Versatile Housing  
 Note: Unique components, accessories, and hardware kits are not typically Included in the Product Certification Test Protocols. Unless otherwise Specified, the Product Certifications referred to herein are predicated upon the base product model configuration.
- FLASH MODE: MULTIPLE FLASH PATTERNS AVAILABLE , SEE INSTALLATION INSTRUCTOINS
- VOLTAGE (NOMINAL): 12 to 24 VDC
- VOLTAGE (EXTREME): 9.0 to 32 VDC
- CURRENT (PEAK): SEE CHART (@ 12 VDC NOMINAL)
- POWER (MAXIMUM): SEE CHART (@ 12 VDC NOMINAL)
- TEMPERATURE RANGE: -22°F (-30°C) TO 122°F (50°C)
- CONNECTION: 9 Foot (2.74 Meters) 4 X 22 AWG Conductor Cable with Black Outer Jacket
- MOUNTING: 1/2 IN. HOLE
- BASE MATERIAL: ALUMINUM
- LENS MATERIAL: NA
- PRODUCT WEIGHT: .32 LBS (0.14 Kg)

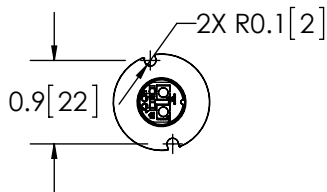

**FRONT VIEW**

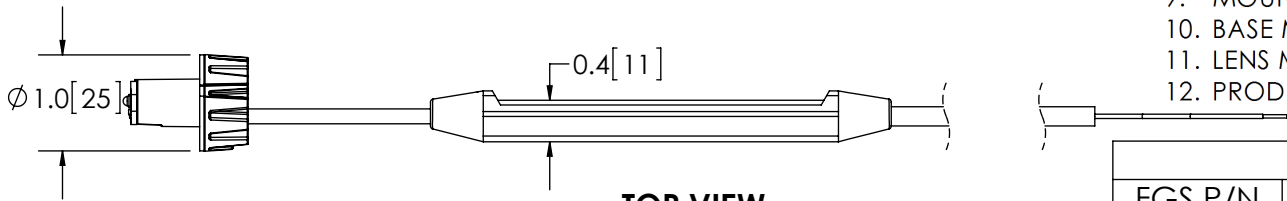

**TOP VIEW**

COLOR CHART			
FGS P/N	COLOR	CURRENT(PEAK)	POWER(MAX)
ED0010A	AMBER	0.5A	5.6W
ED0010B	BLUE	0.8A	10.5W
ED0010W	WHITE	0.9A	11.3W
ED0010R	RED	0.7A	8.3W

NOTES:  
 1. DIMENSIONS IN INCHES[MILLIMETERS (FOR REFERENCE)]

SCALE 1:2		APPROVALS	DATE
CAD GENERATED DRAWING DO NOT MANUALLY UPDATE. MODEL REFERENCED:A		DRAWN BY: BND	2013-02-15
		CHECKED: MDH	2013-02-18
TOLERANCES ARE IN INCHES, AND MILLIMETERS TOLERANCES ARE:		MECH. ENG. NMT	2013-02-18
		ELEC. ENG. TJT	2013-02-15
TEST ENG. JRT	2013-02-20	CUSTOMER PART NO. <b>SEE CHART</b>	
SALES. GLB	2013-02-19		

**ECCO**® Electronic Controls Co.  
 833 West Diamond Street, Boise, ID 83705  
 800-635-5900  
 www.eccolink.com

**HIDE-A-LED, BULLET, SHORT, 12-24VDC**

SIZE: A DWG. NO. ED0010X REV. B

NON DISCLOSURE AGREEMENT  
 THIS DRAWING AND THE DESIGN IT DISCLOSES ARE THE PRIVATE PROPERTY OF ECCO AND IS ISSUED IN CONFIDENCE FOR ENGINEERING INFORMATION ONLY. THE DRAWING AND / OR DESIGN MAY NOT BE USED, COPIED, REPRODUCED, OR OTHERWISE DISCLOSED IN PART OR AS A WHOLE TO OUTSIDERS OR USED FOR ANY OTHER PURPOSE WITHOUT THE PRIOR WRITTEN CONSENT OF ECCO. THE DRAWING IS SUBJECT TO RECALL AT ANY TIME. YOUR POSSESSION OF THIS DOCUMENT CONSTITUTES ACCEPTANCE OF THESE TERMS. © 2013 ECCO

