

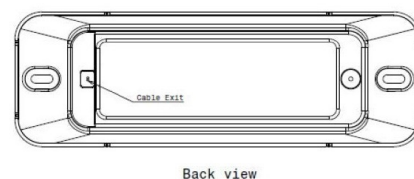

391.MTL200VVG

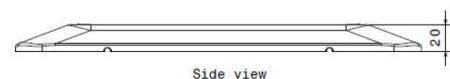

391.MTL200VVW

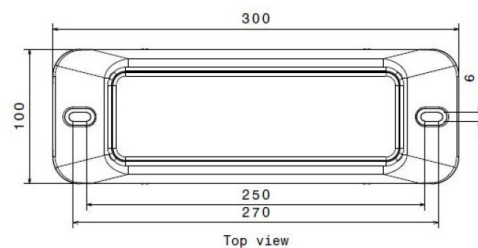

Designed with an incredibly tough die-cast aluminium housing, high impact polycarbonate lens and a 1500lm diffused LED illumination, this premium product provides users with “best in class” performance.

- » Multi-voltage operation (10-30V)
- » Un-switched version
- » Available in grey / silver or white (other colours available on request)
- » Resistant to knocks, bumps and vibration
- » 1500lm output light unit with smooth optical appearance high impact polycarbonate lens
- » Low profile design
- » Reliable in extreme temperatures (tested between -30°C and +40°C)
- » Also available with PIR sensor
- » Premium die-cast powder coated aluminium housing with GORE breathing system preventing condensation
- » Diffused super-wide optical beam for improved illumination spread
- » ECE Regulation 10 approved
- » IP68 rated
- » 2 year warranty

Part Number	391.MTL200VV
Operating Voltage	10-30V
Current Draw	0.85A @ 12V DC 0.42A @ 24V DC
Light Features	Un-switched
Technology	LED
Light Output	1500 Lumens
Colour Temperature	Bright White 6000K
Mounting	Surface Mount
Connection	Fly Lead
Housing Colour	Grey / Silver or White
Materials	Body - Powder Coated Aluminium Lens - Polycarbonate
IP Rating	IP68
Approval(s)	ECE R10
Dimensions	300mm (l) x 100mm (w) x 20mm (d)
Warranty	2 Years

www.dun-bri.com